

VEZO CLADDING

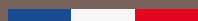

TIMBER SPECIES

DOUGLAS FIR



DIMENSIONS

COVER WIDTH : 125 MM
THICKNESS : 19 MM

AESTHETICS



COLOURED IMPREGNATION

BROWN

GREY



FEATURES

TECHNIQUE	Glulam
SURFACE FINISH	Micro-ribbed
LAYING	Horizontal
LENGTH	4 m
ON SITE STORAGE	Protected from water and UVs Maximum natural ventilation
MOISTURE CONTENT	Kiln dried before impregnation, air dried after impregnation
MOISTURE CONTENT AT INSTALLATION	18 to 20% (must be controlled before laying the cladding)
DURABILITY	Resistant to termistes, rot and wood boring insects
WEIGHT/M²	10kg/m ²
BOARD ENDS	Square ends. The joints must be positioned on the battens with a 5mm gap

USE CLASS	Up to Use Class 3.2
DESIGN	Designed for better water drainage as per FD P 20-651
FIRE RATING	M3 (as per DTU 88) Ds2d0 (Euroclasses)
MAINTENANCE	Regular low pressure water jet cleaning with a sponge using soft water or a neutral PH soap
FIXINGS	2 stainless steel annular ring shank nails per board
GUARANTEE	10-year guarantee for vacuum pressure treated Douglas fir cladding for use above ground and for Use Classes up to 3.2

LAYING YOUR CLADDING

Please refer to the requirements referenced in Standard Technical Documents (DTU) 41.2 of August 2015.

- 2 stainless steel annular ring shank nails per board

SUPPORT BATTENS :

- UC3 25x47mm double battens fixed vertically and horizontally at 60cm spacings

IMPORTANT :

- Install double battens to ensure the best ventilation behind the

cladding and airflow between the joists

- Allow for a water drop to form at the bottom board ends (angle cut)
- Protect top board ends from the elements

FOR 1M² OF VEZO CLADDING AND 60CM SPACING :

- 8 lm of cladding
- 2 lm of battens
- 28 nails

HORIZONTAL INSTALLATION

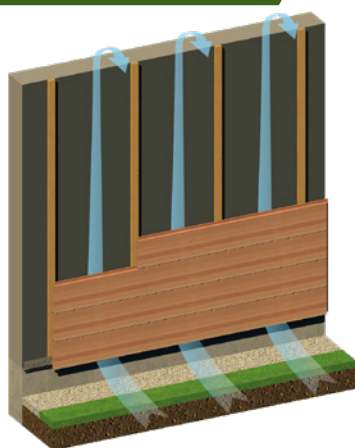

PROFILE

